

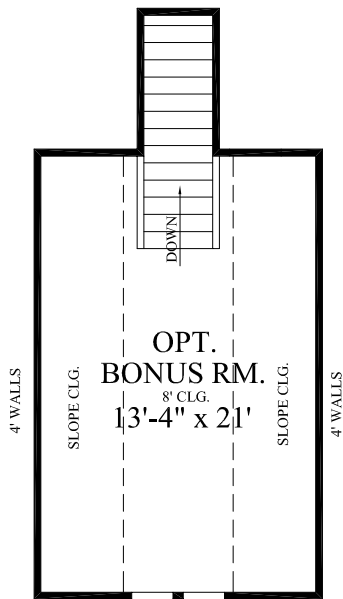

FRONT ELEVATION - PLAN: 2293

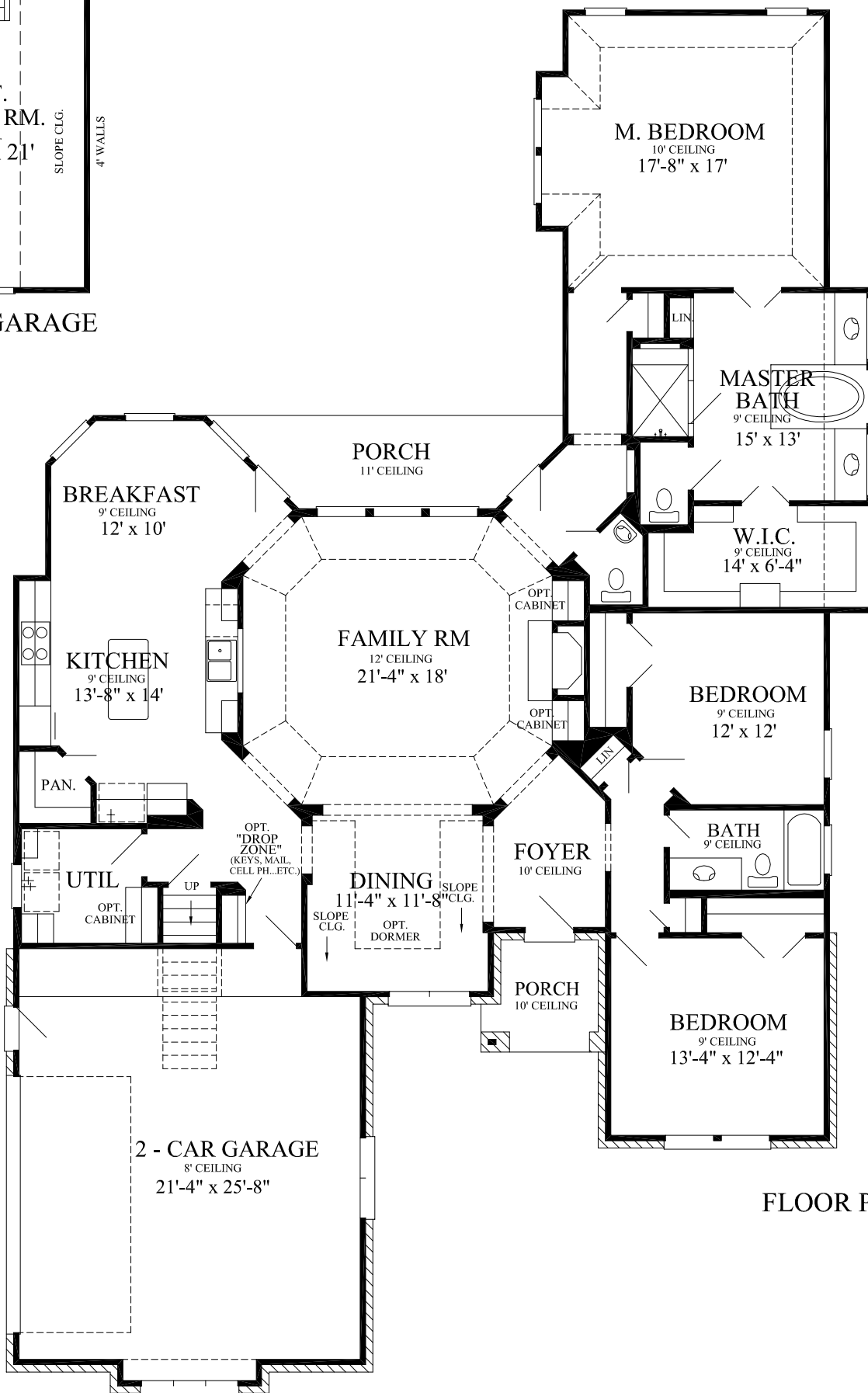

BONUS ABOVE GARAGE



FLOOR PLAN



| FOOTAGE:       |            |
|----------------|------------|
| TOTAL LIVING:  | 2293 SQ/FT |
| GARAGE:        | 605 SQ/FT  |
| PORCHES:       | 154 SQ/FT  |
| TOTAL COVERED: | 3052 SQ/FT |

OPT. BONUS RM ADDS: 300 SQ/FT

WIDTH: 54'-6"  
DEPTH: 86'-6"

notice."

"Architectural dimensions shown are nominal exterior dimensions, room sizes, window placements and other dimensions may vary from these drawings. This brochure is for illustration purposes only. They are not part of a legal contract. Bilmar Homes reserves the right to change product, features, brand names, architectural design and details without

3 BEDROOM - OPT. BONUS RM - 2 1/2 BATH - 2 CAR GARAGE